

1. Application 用途

- ◆ Industrial Power Supply

2. Features 特性

- ◆ Comply with IEC62368
- ◆ ≥98% Efficiency
- ◆ ROHS、Reach Compliant
- ◆ Operating Temperature Range: -40℃ to +155℃

3. Picture 图片



4. Schematic 原理图

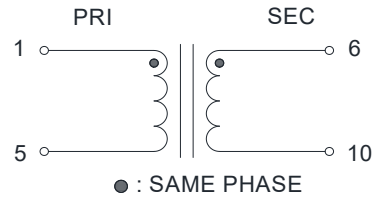

5. Dimension (Unit: mm) 外形尺寸

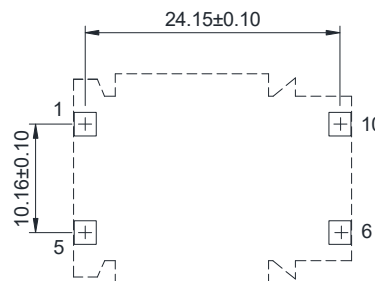
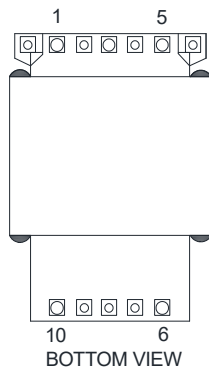
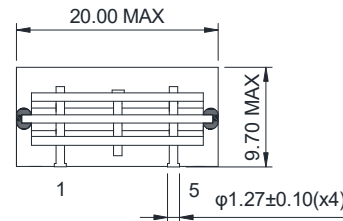
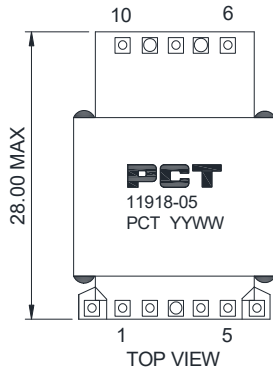

6. Electrical Characteristics 电气特性

Electrical Specifications@25℃

Part NO.	Output power(W)	Inductance (uH) 10KHz,0.1V		Lk(uH)MAX 100KHz,0.1V	Turns Ratio 20KHz,1V	DCR (mΩ MAX)				HI-POT(VAC) 0.3mA/3S
		1-5	6-10	6-10		1-5	6-10	/	/	SEC- PRI
11918-05	60	1-5	6-10	6-10	1-5-6-10	1-5	6-10	/	/	SEC- PRI
		84.9 MIN	339.6 MIN	0.5	1:2	7.5	62.0	/	/	2000