

1. Application 用途

- ◆ Industrial, medical and so on

2. Features 特性

- ◆ Storage conditions: $-40^{\circ}\text{C}\sim+85^{\circ}\text{C}$.
- ◆ ROHS、Reach Compliant
- ◆ Operating Temperature Range: -40°C to $+125^{\circ}\text{C}$

3. Picture 图片

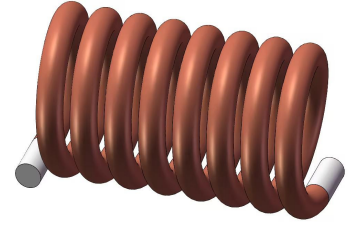

4. Schematic 原理图

5. Dimension (Unit: mm) 外形尺寸

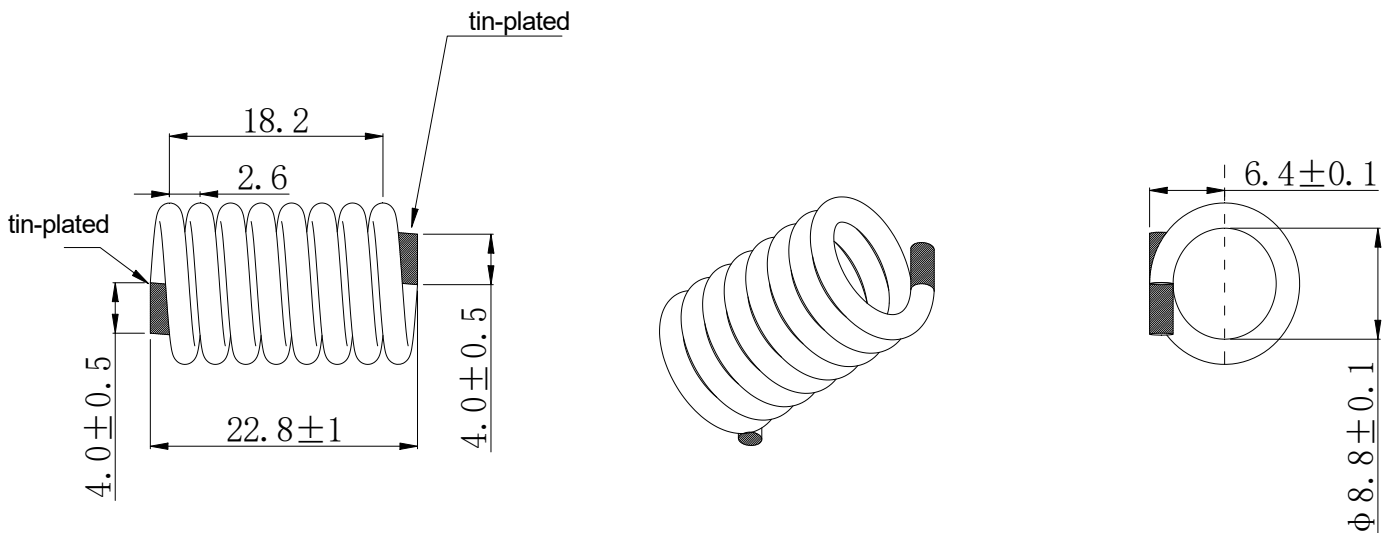

3. Electrical Characteristics 电气特性

Electrical Specifications@25°C				
Part NO.	Inductance (nH) 63.86MHz, 1V	Turns Ratio 20KHz, 1V	DCR (Ω MAX)	HI-POT(VDC) 1mA/60s
2700022-0617	S-F	N1	S-F	-
	210 ± 1nH	-	2.0	-